

SMARTPACK

SERIES

1-2-3 kVA

1:1

PHASE

ONLINE UPS



HOME/OFFICE



EMERGENCY



MEDICAL



INDUSTRY



UPS ONLINE



TOWER



POWER FACTOR



PLUG & PLAY



Power Protection for Entry Level IT Servers & Networks

- + High Frequency and True Double-Conversion
- + Microprocessor Control Optimizes Reliability
- + Active Power Factor Correction (PFC)
- + Wide Input Voltage Range (110~300V)
- + Output Power Factor 0.9
- + Auto Sensing Frequency
- + ECO Mode Operation for Energy Saving
- + Selectable Output Voltage via LCD
- + Output Bypass Settable via LCD
- + Power-On Self Test
- + Advanced Battery Management (ABM)
- + Short Circuit and Overload Protection
- + Automatic Charging in Off Mode
- + Auto Fan Speed when Loads Varies
- + Generator Compatible
- + RS232 Port and RJ45 Protection



- + High Output Power Factor 0.9
- + High Energy Savings
- + Smart Charger Technology



MODEL			
Capacity	1kVA / 900W	2kVA / 1800W	3kVA / 2700W
INPUT			
Nominal Voltage	200V / 208V / 220V / 230V / 240 VAC		
Voltage Range	110 ~ 300 VAC or 55 ~ 150 VAC @ 60% Load, 160 ~ 300 VAC or 80 ~ 145 VAC @ 100% Load		
Frequency Range	45 ~ 55 Hz / 55 ~ 65 Hz (Auto-Detect)		
Power Factor	> 0.99 @ Nominal Voltage (100% Load)		
THDi	<=10%		
OUTPUT			
Voltage Range	200V / 208V / 220V / 230V / 240 VAC		
Voltage Regulation	±1%		
Frequency (Synchronized Range)	45 ~ 55 Hz / 55 ~ 64 Hz		
Frequency (Batt. Mode)	50 Hz ±0.1 Hz or 60 Hz ±0.1 Hz		
Crest Factor	3:1 (Max)		
Harmonic Distortion	<2% THD (Linear Load); <=5% THD (Non-Linear Load)		
Transfer Time	AC to DC	Zero	
	Inverter to Bypass	4ms (Typical)	
Waveform	Pure Sinewave		
EFFICIENCY			
Mains Mode	Up to 90% @ Battery Full Charged	Up to 91% @ Battery Full Charged	
ECO Mode	94% @ Battery Full Charged		
BATTERIES			
DC Voltage	24V 36 V	48V 72V	72V 96V
Inbuilt Battery	2 x 7Ah External	4 x 9Ah External	6 x 9Ah External
Charging Current (Max.)	1A 6A	1A 6A	1A 6A
Recharge Time	8 hour		
INDICATORS			
LCD	Load Level, Battery Level, AC Mode, Battery Mode, Bypass Mode and Fault Indicators		
ALARMS			
Battery Mode	Sounding Every 4sec		
Low Battery	Sounding Every 1sec		
Overload	Sounding Twice Every 1sec		
UPS Fault	Continuously Sounding		
ENVIRONMENTAL			
Operating Temperature	0 ~ 40°C		
Relative Humidity	0 ~ 90% (Non-Condensing)		
Noise Level	≤50 dB (1m)		
COMMUNICATION			
RS232 (Standard) / USB (Optional)	Supports Windows®2000/2003/XP/Vista/2008/Windows®7/8/10, Linux, Free BSD and Mac		
SNMP (Optional)	Power Management from SNMP Manager and Web Browser		
DIMENSIONS & WEIGHT			
Dimension WxDxH (mm)	144 x 400 x 215	191 x 468 x 340	
Net Weight (kg)	7.3 5.1	18.1 8.8	24.4 10.1
Gross Weight (kg)	8.5 6.1	19.5 9.8	25.8 11.1

Ensmart reserves the right to change or modify product design, construction, specifications, or materials without prior notice and without incurring any obligation to make such changes and modifications on Ensmart products previously or subsequently sold. Ensmart does not guarantee the items of the accuracy and completeness.

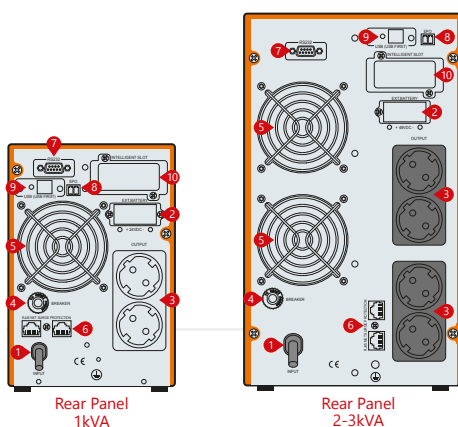

1. AC Input
2. DC Input
3. Outlet
4. Breaker
5. Fan
6. Modem/Tel/Fax
7. RS232
8. USB (Optional)
9. EPO (Optional)
10. SNMP/AS400 (Optional)

- Options :**
- USB/SNMP Port
 - Emergency Power Off (EPO)
 - Extension Battery Bank
 - Built-In Isolation Transformer